

AQUASHIELD PLUS Flexible Waterproofing

COMPANY INFORMATION

ALLGEMEINE BAU-CHEMIE PHIL., INC.
Address: 10/F Asian Star Building, 2404 Asean Drive,
Fillinvest City, Alabang, Muntinlupa City 1781 Philippines
Tel: (+63 2) 88426891 • Fax: (+63 2) 88427146 • info@abc.ph • www.abc.ph

PRODUCT NAME

AQUASHIELD PLUS Flexible Waterproofing

PRODUCT DESCRIPTION

AQUASHIELD PLUS is a 2-component flexible cementitious waterproofing compound formulated for direct application over concrete surfaces.

CLASSIFICATION STANDARD

- ✓ ASTM D412 (USA) American Society for Testing & Materials
- ✓ ASTM D4541 (USA) American Society for Testing & Materials
- ✓ ASTM D836 (USA) American Society for Testing & Materials
- ✓ ASTM E96 (USA) American Society for Testing & Materials
- ✓ PNS ISO 13007-5:2016 (PH) Philippine National Standards International Organization for Standardization

USES

- Swimming pool, shower area, water tank, firewall, roof deck, floor slabs above & below ground, CHB wall, gutter, plant box, etc.
- Concrete surfaces where water, moisture or condensation is a problem
- Non-structural repair work for minor hairline cracks

PROPERTIES

- ✓ **Long-term protection against water leaks & seepage**
- ✓ **Flexible** - non-structural hairline cracks can be easily bridged to maintain the integrity of the waterproofing barrier
- ✓ **Superior bonding with concrete substrate**
- ✓ **Fast & easy** - direct application on concrete surfaces
- ✓ **Compatible with further finishing** (tile installation, plaster, mortar topping, thin plaster, epoxy coating, elastomeric or rubber paint)
- ✓ **Non-toxic** - suitable for concrete potable water tank, cistern tank & fish pond
- ✓ **Time saving** - apply on new concrete which has cured at least 7 days
- ✓ **Eco-friendly** - composed of natural ingredients bearing little or no adverse effects to the environment. It has zero harmful chemical additives & odors, creating a safe living environment for you & your family.

SECTIONAL DETAIL

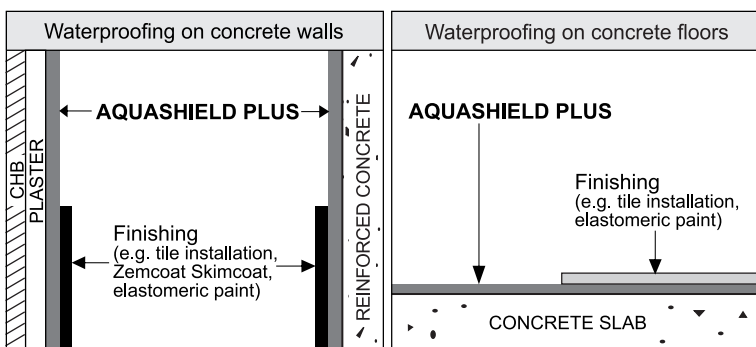

SURFACE PREPARATION

The surface must be fully cured, structurally sound, stable, clean and free of paint & contaminants such as dirt, dust, loose material, oils and chemicals. **Dampen concrete surface well before waterproofing application to prevent suction and premature curing especially during hot & windy conditions.**

| SUBSTRATE | SURFACE PREPARATION |
|------------------|--|
| New concrete | Apply on new concrete which has cured at least 7 days |
| Smooth concrete | Direct application |
| CHB | Walls must be plastered & cured |
| Painted concrete | Abrade paint (w/ steel brush and paint remover) |
| Repair work | Floors: remove mortar topping & damaged waterproofing Walls: remove paint, blistering plaster, etc. |

⚠ In areas with continuous water seepage, use Aquaplug Hydraulic Cement to instantly stop the penetration of water prior to application of Aquashield Plus.

APPLICATION GUIDE

1. Mixing

In a clean plastic pail, pour Aquashield Plus liquid (component A) & add Aquashield Plus powder (component B). Stir to attain a smooth and lump-free consistency. For best results, use an electric mixer.

⚠ **Use only non-absorptive materials as mixing base (plastic pail or G.I. sheet).** Using absorptive materials such as concrete, plywood, fiber cement board or cardboard will affect the chemical properties of the product which can result in bonding failure and poor product performance.

| MIXING RATIO | | | POT LIFE |
|-----------------|----------------------|----------------------|----------|
| AQUASHIELD PLUS | Component A (liquid) | Component B (powder) | |
| 4.5 kg set | 3.5 kg | 1 L | 1 hour |
| 36 kg set | 27 kg | 9 L | |

2. Application

Apply Aquashield Plus using a stiff bristle brush (Tampico brush) with a **minimum of 2 coats** where each coat is applied in a different direction (**horizontal & vertical**), ensuring full surface coverage & no pinholes. After the 1st coat, wait 4 - 6 hours before the 2nd coat. Aquashield Plus must cure for at least 3 days depending on application area, weather & site conditions. **Conduct a flood test and wait for 24 hours prior to further finishing.**

⚠ **TIP:** Where water seepage or infiltration is heavy, a 3rd coat is recommended. Observe same time interval and procedure.

⚠ For areas exposed to direct sunlight cover with a damp cloth to prevent premature curing. During rainy season, protect with plastic sheet to prevent application from being washed out.

3. Finishing

Any waterproofing membrane must be protected with further finishing against possible damage.

Preparations must be done accordingly:

- **Mortar topping** - apply mortar topping with Zembond admixture directly
- **Zemcoat Skimcoat** (thin plastering) - prior to skimcoat, apply Redifix slurry. Slurry must cure for at least 4 hours or overnight.
- **Tile installation** - apply ABC Tile Adhesive directly
- **Epoxy coating, elastomeric or rubber paint** - apply paint directly

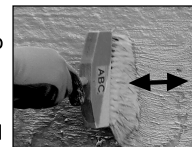

CURING TIME

3 days
(minimum)

COVERAGE (approx.)

| AQUASHIELD PLUS | 2 coats | 3 coats |
|-----------------|------------------------|-------------------------|
| 4.5 kg set | 1 - 1.5 m ² | 0.75 - 1 m ² |
| 36 kg set | 10 - 12 m ² | 8 - 9 m ² |

Note: Coverage is dependent on substrate condition, workmanship and number of coats applied.

PACKAGING

4.5 kg set & 36 kg set (each set has 2 components - liquid & powder)

CLEANING & SAFETY

Use clean water to remove excess material on tools before it hardens. Avoid eye exposure and prolonged skin contact. Do not inhale or ingest. In case of irritation, rinse with sufficient water. If symptoms persist, consult your doctor.

STORAGE & SHELF LIFE

When stored in a cool dry place & in its original unopened packaging, Aquashield Plus will remain usable one year from date of manufacture.

WARRANTY

Due to variety of applications, different working methods and the various properties of bases, we cannot assume responsibility or liability with regard to the application of our products. Our guarantee and liability are restricted to the quality of our products at the time of acceptance of the customer of such products. In no case shall our liability extend beyond replacement of defective products, if any, found at the time of acceptance. For all deliveries and services, our General Sales Condition including warranties stipulated for each case are valid.

